

FORMAX® PLUS Cold Forming Machine

Product Overview

The FORMAX PLUS cold former meets the challenge of difficult-to-transfer and tight-tolerance jobs with the patented Pick-Move-Place transfer. The FORMAX PLUS cold forming machine has all the standard features of the FORMAX 2000 cold forming machines such as Zero Clearance Heading slide guiding, Sealed Heading slide liners, and Precision linear feed, but the FORMAX Plus also has increased forming tonnage, larger cutoff capacity, and expanded die space.



FORMAX Quick Change

FORMAX pioneered the quick-change concept with a Formapak system that can be removed from the machine and set up externally on a Formapak setup fixture. The FORMAPAK is one unit that incorporates the diepak, punchpak, transfer, transfer camshaft, cutter and quill. After the installation of the FORMAPAK, computer controls simplify the adjustment of machine settings. Motor drives make accurate and repeatable kick out adjustments during this automated process. [Read more about FORMAX quick change over and setups.](#)

FORMAX PLUS "S" models are designed and equipped for maximum productivity running short, difficult to handle shapes including parts with short shanks or no shanks at all. FORMAX PLUS offers the same Medium and Long length ranges which have always been available on FORMAX and FORMAX 2000 cold formers. FORMAX PLUS expands the capability with increased tonnage, large cutoff diameter and expanded die space. With Pick-Move-Place transfer and alternate blow, FORMAX PLUS Medium and Long work models take on those high load, tough to form jobs and like all FORMAX, they changeover in minutes.

FORMAX® PLUS : 3-7 Dies, Short, Medium, Long Work Models

FORMAX® PLUS	Cutoff Diameter	SPM-Max
FXP5	20	190
FXP4	16	240
FXP3	12	300
FXP2	9	330

All dimensions are in millimeters unless otherwise noted. Max speed refers to shortest stroke model specification.

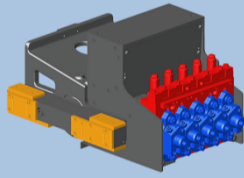

Zero-Clearance Heading Slide Guiding

The Zero-Clearance Heading Slide is a 2-axis design that utilizes fixed liners that provide 'Zero Clearance' during the work stroke of the machine. Zero Clearance Heading Slide Guidance system precisely aligns punches to dies, and part concentricities are held to tolerances once thought impossible.

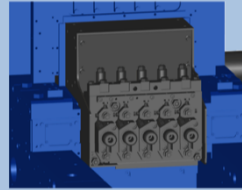

Sealed Heading Slide Liners

FORMAX is the only Cold Forming machine designed with heading slide liners that are Sealed to prevent foreign materials from damaging the liners and causing excess/pre-mature wear.

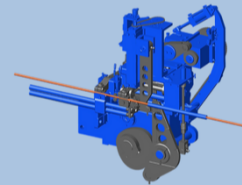

Precision Linear Feed

Linear feeding obsoletes traditional feed roll designs with superior cut off blank accuracy without the need for a stock gauge. The linear feed grips are designed to handle the full range of wire diameters so only one set of grips is needed, unlike traditional feed rolls. Linear feed also delivers more precise blanks while eliminating the problems associated with feed clutches and brakes.

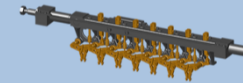

Pick-Move-Place Transfer

Pick Move Place allows for excellent control of complex part shapes, and is ideal for head heavy, difficult to transfer parts. The extra wide finger opening capability clears larger punches.