

LeanFX Cold Forming Machine

Product Overview

LeanFX combines the high performance standards of FORMAX® with the ease of operation and competitive pricing demanded by today's global marketplace.

Many of the same innovative, production-proven features that were introduced on FORMAX, are standard on LeanFX, including Linear Feed, Zero-Clearance Heading Slide, Straight-Across Transfer and Sealed Heading Slide Liners. This global machine can produce high-quality fasteners and parts faster than any cold former on the market.



LeanFX is a FORMAX with efficient change-over features, designed to appeal to a wide range of standard and specialty fastener markets. Ideally suited for long production runs, LeanFX is equipped with simplified features such as Manual Adjustment of Feed and Die Kickout Length, a combined Electrical Control Cabinet and Operator Push-Button Station, and a Magnetic Finished Parts/Scrap Discharge Conveyor. A Free-Standing Sound Enclosure with new look and sound proof capability is also part of the standard machine configuration. The machine is available with the standard Straight-Across transfer or with Cold Former transfer in the 5-die version.

LeanFX is assembled at NM China, National Machinery's wholly-owned facility in Suzhou, China. There, National Machinery personnel use the latest machine tools, inspection, assembly, and testing practices to ensure the highest level of quality. National Machinery experts in the areas of engineering, machining, assembly, and quality are stationed at NM China to ensure "National" quality of any product.

LeanFX: medium and long work models

LeanFX		Dies	Cutoff Diameter	SPM-Max
Lean	FX8	2-6	9	400
Lean	FX10	2-6	12	300
Lean	FX14	4-6	14.8	240
Lean	FX18	4-6	18.5	190
Lean	FX10 CF	5	12	200
Lean	FX14 CF	5	16	160
Lean	FX18 CF	5	20	130

All dimensions are in millimeters unless otherwise noted. Max speed refers to shortest stroke model specification.

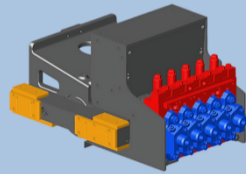

Zero-Clearance Heading Slide Guiding

The Zero-Clearance Heading Slide is a 2-axis design that utilizes fixed liners that provide 'Zero Clearance' during the work stroke of the machine. Zero Clearance Heading Slide Guidance system precisely aligns punches to dies, and part concentricities are held to tolerances once thought impossible.

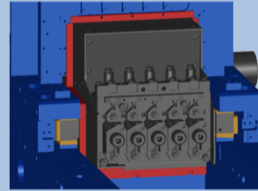

Sealed Heading Slide Liners

FORMAX is the only Cold Forming machine designed with heading slide liners that are Sealed to prevent foreign materials from damaging the liners and causing excess/pre-mature wear.

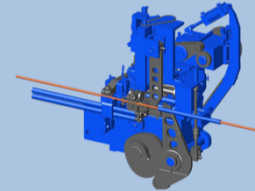

Precision Linear Feed

Linear feeding obsoletes traditional feed roll designs with superior cut off blank accuracy without the need for a stock gauge. The linear feed grips are designed to handle the full range of wire diameters so only one set of grips is needed, unlike traditional feed rolls. Linear feed also delivers more precise blanks while eliminating the problems associated with feed clutches and brakes.

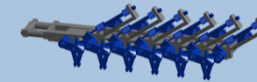

Straight Across Transfer

FORMAX 2000's zero clearance transfer system moves blanks across the dies. Is designed for greater machine speed and consistency than traditional transfers.